

**10310/177-219 Mitchell Road Erskineville NSW**

1  1  1 

Desirably positioned in the revered 'Sydney Park Village' and offering exceptionally peaceful and private in/outdoor living, this generously proportioned one bedroom lifestyle apartment is the perfect hybrid of resort-style ambience and optimum convenience.

**Type** : Apartment

**Price** : \$ 683,000

**View** : <https://www.beaumccaffery.com.au/3193270>

Expansive open plan living/ dining that allows for relaxation & entertaining

North facing terrace offering optimum privacy & leafy internal outlook

Well-appointed gas kitchen w/ s/s appliances & plentiful storage

Large sun drenched bedroom w/ floor-to-ceiling BIR & direct balcony access

Contemporary bathroom w/ tub & separate laundry room w/



**Melissah McCaffery J P**

**02 9565 5333**

[For full version visit the website](https://www.beaumccaffery.com.au)

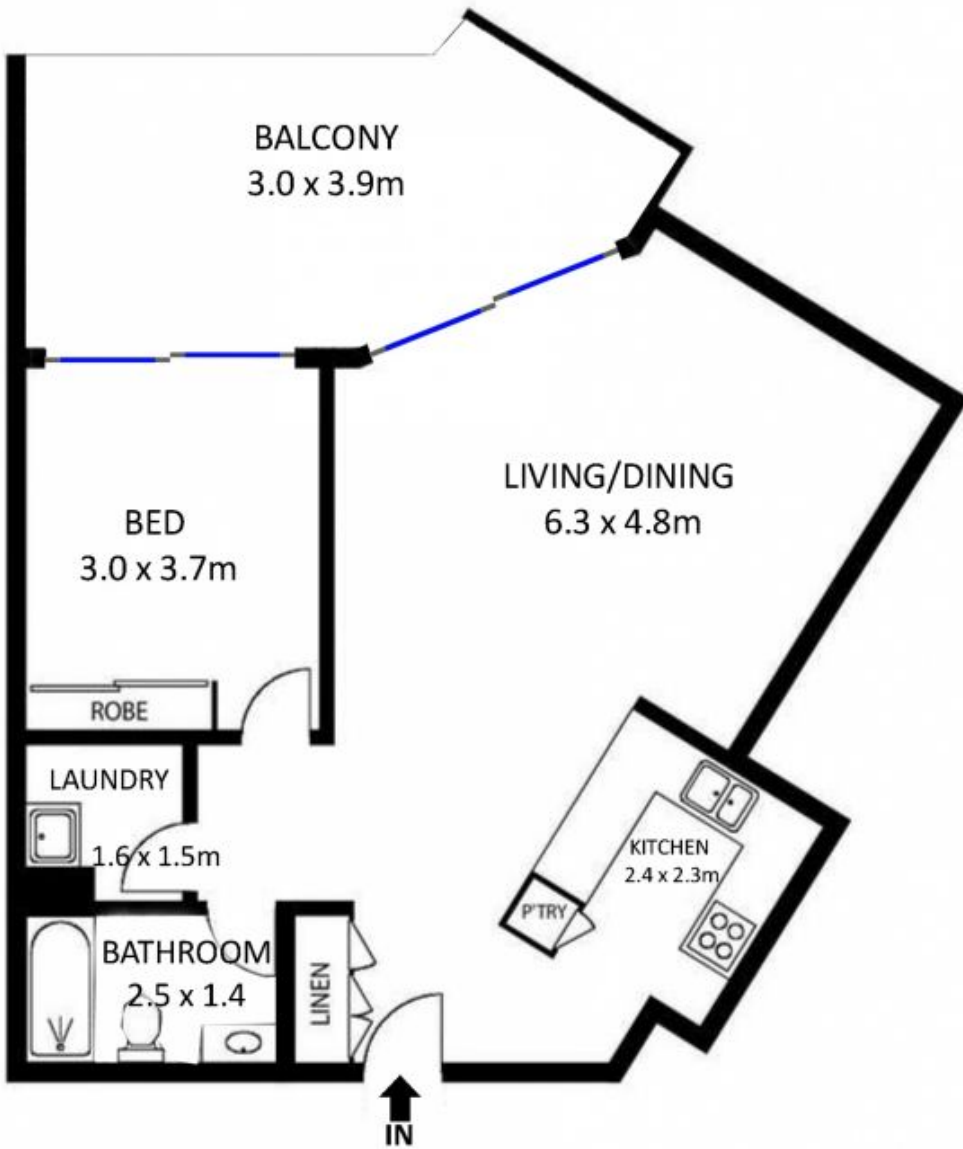

LEVEL THREE

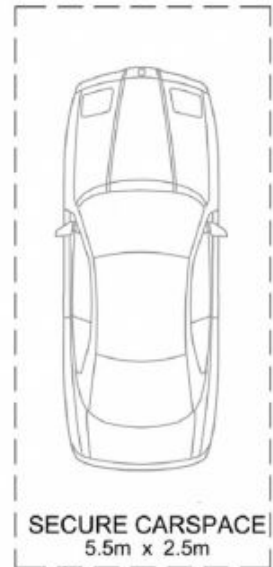

BASEMENT

10310 / 177-219 Mitchell Road, Erskineville



DISCLAIMER: THIS PLAN IS FOR ILLUSTRATIVE PURPOSES ONLY. DIMENSIONS ARE APPROXIMATE AND IT DOES NOT CONSTITUTE PART OF ANY LEGAL DOCUMENTS. DIMENSIONS ARE APPROXIMATE AND IT DOES NOT CONSTITUTE PART OF ANY LEGAL DOCUMENTS.