



**11305/177-219 Mitchell Road Erskineville NSW**

1  1  1 

Situated in the sought-after landmark 'Sydney Park Village', this one bedroom apartment featuring a private aspect w/ desirable park views offers oversized living spaces + a designated study. Step into a convenient urban position in a sought-after location, so close to Erko village life & the CBD. Enjoying an in/out-door flow that allows for relaxation or entertaining - this is low maintenance inner west living at its optimum.

Double brick & quality building  
 Generous open plan living and dining area  
 Private entertainer's balcony w/ views to Sydney Park  
 Quality gas kitchen w/ s/steel appliances & plenty of storage  
 Generous bedroom w/ built in robe & private outlook

[For full version visit the website](https://www.beaumccaffery.com.au)

**Type** : Apartment  
**Price** : \$ 720,000  
**Land Size** : 79 sqm  
**View** : <https://www.beaumccaffery.com.au/7369765>



**Melissah McCaffery J P**  
02 9565 5333



**Michael McCaffery**  
02 9565 5333

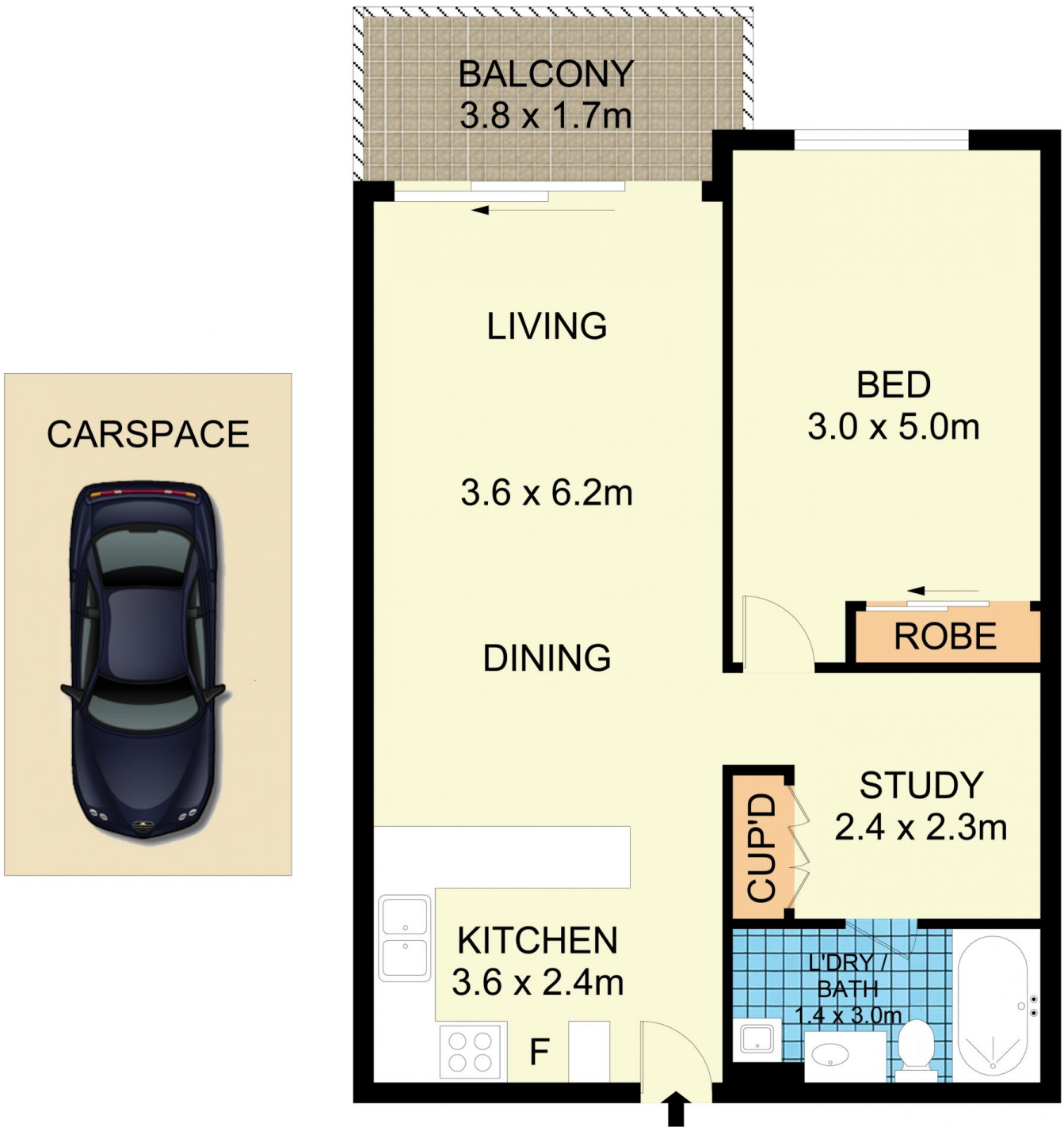

11305/177-219 Mitchell Road, Erskineville

**Disclaimer**

Floor Plan measurements are approximate and are for illustrative purposes only. While we cannot doubt the floor plans accuracy, we make no guarantee, warranty or representation as to the accuracy and completeness of the floor plan.