

2305/8 Eve Street Erskineville NSW

1  1  1 

Situated in the sought after Motto complex, designed by award-winning architects Allen Jack + Cottier, this recently updated split level apartment enjoys all day natural light, modern-contemporary interiors & in/outdoor entertaining. It really is the best of inner city living in an exceptional lifestyle pocket of Erskineville with its hip & gorgeous leafy ambiance.

Type : Apartment
Price : \$ 820,000
Building Size : 73 sqm
Land Size : 73 sqm
View : <https://www.beaumccaffery.com.au/7917467>

Open plan living & dining area w/ floor to ceiling glass & air-conditioning
 East facing balcony w/ desirable internal garden & pool views
 Designer gas kitchen w/ s/s appliances
 Impressive timber & wire tread structure staircase leads to the mezzanine level w/ double bedroom, double built-in

[For full version visit the website](https://www.beaumccaffery.com.au)



Melissah McCaffery J P
 02 9565 5333



Michael McCaffery
 02 9565 5333

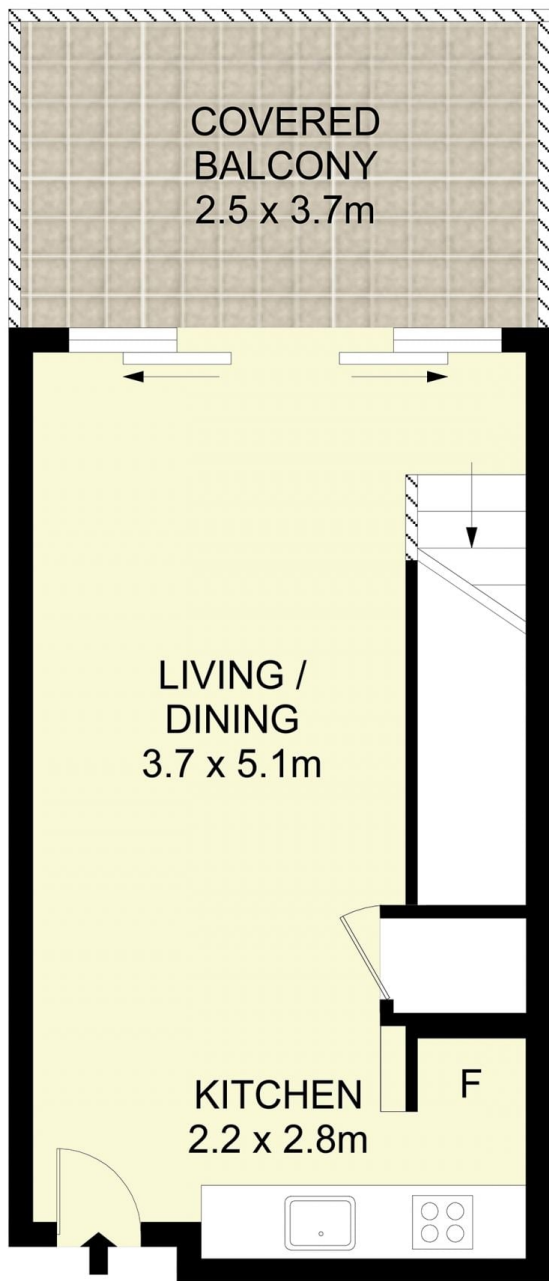
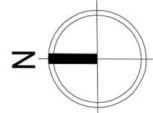

ENTRY LEVEL

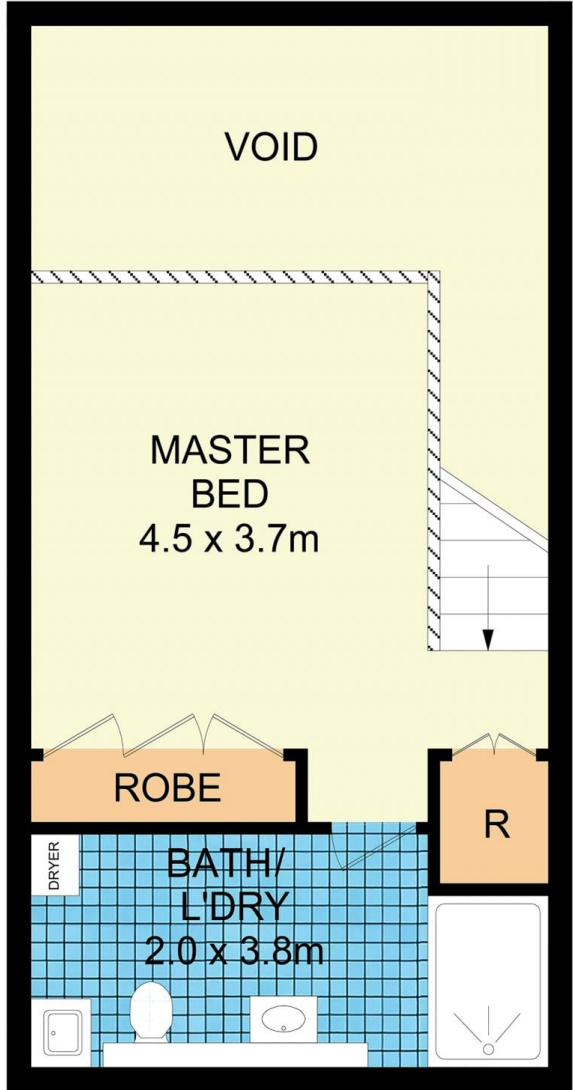

LEVEL 1



2305/8 Eve Street, Erskineville



Disclaimer
Floor Plan measurements are approximate and are for illustrative purposes only. While we cannot doubt the floor plans accuracy, we make no guarantee, warranty or representation as to the accuracy and completeness of the floor plan