

17506/177-219 Mitchell Road ERSKINEVILLE NSW

1  1  1 

Nestled in the vibrant heart of Erskineville, positioned on the fifth floor, this beautifully presented North facing apartment combines modern style w/ functional living. Featuring updated interiors, new kitchen, separate study ideal for a home office/nursery/banquet seating/library, the light filled open plan living & dining area extends effortlessly to a full length entertainer's balcony. Soaking up the village ambience of Erskineville's vibrant urban shopping, café & dining precinct, this apartment is the perfect introduction into Sydney's sophisticated city fringe lifestyle - the ideal first home, downsize or lucrative investment for the savvy opportunist.

Double brick & quality building
Floor to ceiling glass sliding doors enabling an abundance

[For full version visit the website](https://www.beaumccaffery.com.au)

Type : Apartment
Price : \$ 905,000
Building Size : 87 sqm
Land Size : 87 sqm
View : <https://www.beaumccaffery.com.au/8342066>



Melissah McCaffery J P
02 9565 5333



Michael McCaffery
02 9565 5333

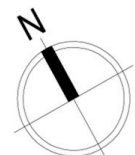
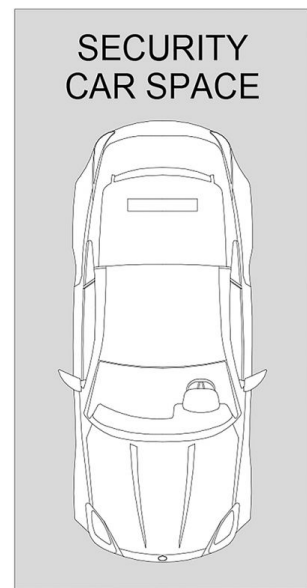
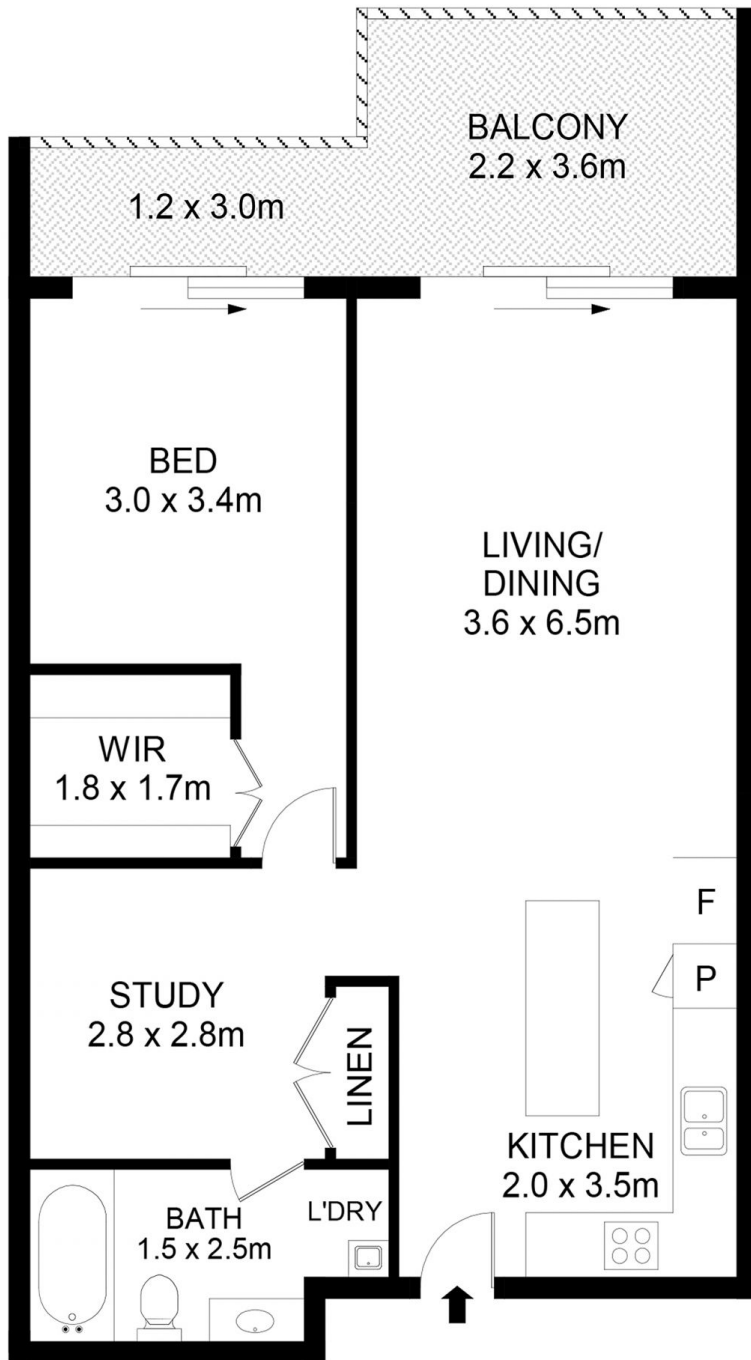

Disclaimer

Floor Plan measurements are approximate and are for illustrative purposes only. While we cannot doubt the floor plans accuracy, we make no guarantee, warranty or representation as to the accuracy and completeness of the floor plan