



16106/177-219 Mitchell Road ERSKINEVILLE NSW

1  1  1 

Nestled in the vibrant heart of Erskineville, this accessible North-facing ground floor apartment offers the ideal mix of resort-style living & urban convenience. Bathed in natural light, the open plan lounge & dining area flows effortlessly to a sun-filled courtyard, creating the perfect setting for alfresco dining, entertaining, or simply relaxing outdoors. The well-proportioned bedroom & functional layout being positioned on the ground floor provides immediate comfort & accessibility while also offering excellent scope to update & add future value. Appealing to first home buyers, young professionals, downsizers, or investors alike - this apartment is both a welcoming retreat & a smart lifestyle investment in one of the Inner West's most desirable communities.

Type : Apartment
Building Size : 112 sqm
Land Size : 112 sqm
View : <https://www.beaumccaffery.com.au/8459197>



Melissah McCaffery J P
02 9565 5333



Michael McCaffery
02 9565 5333

[For full version visit the website](https://www.beaumccaffery.com.au)

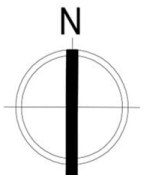
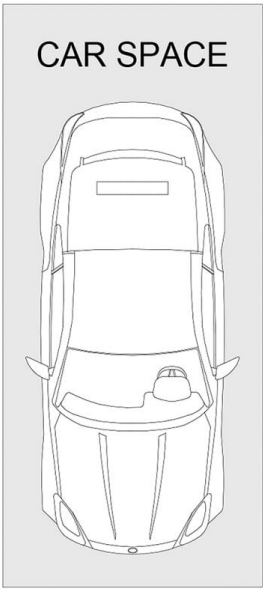
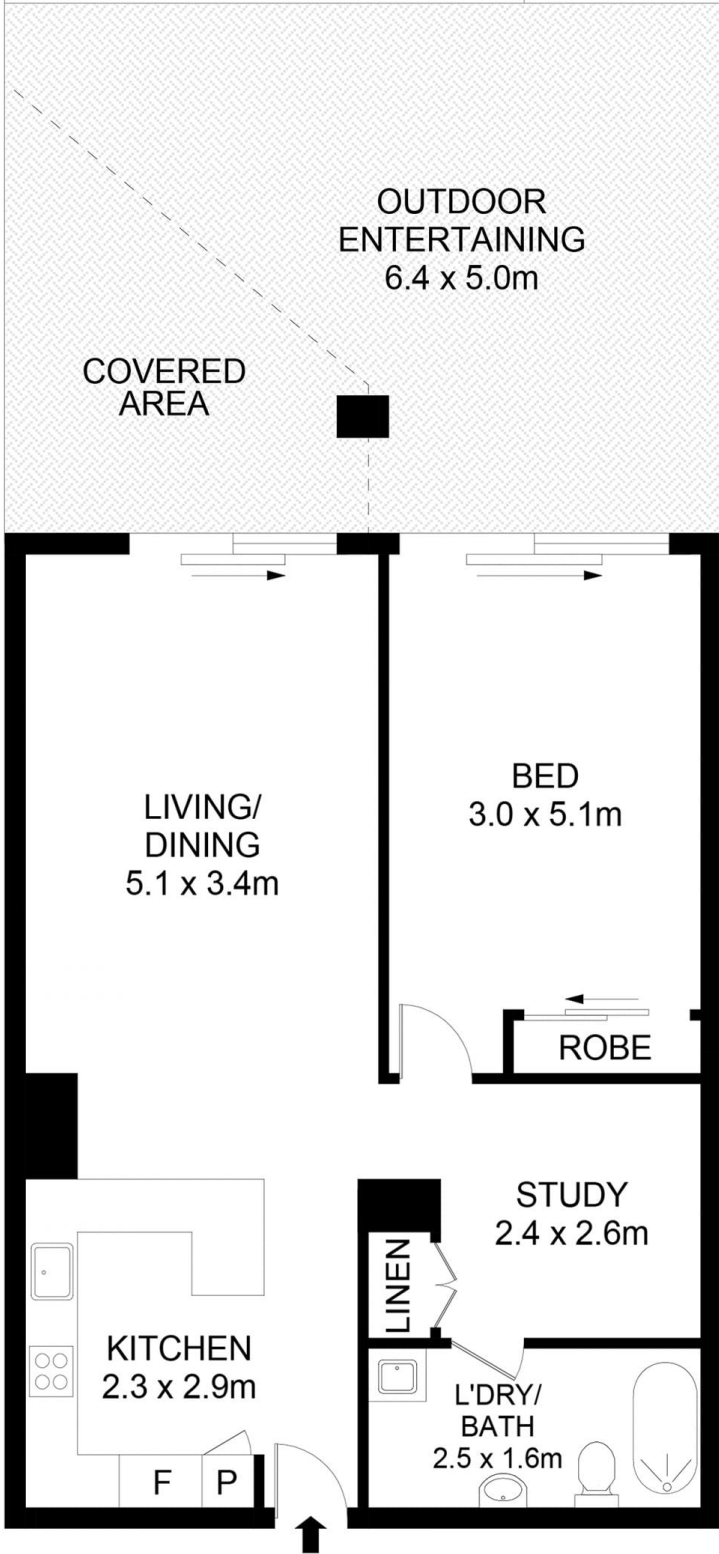
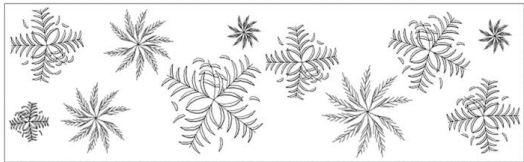

Disclaimer
Floor Plan measurements are approximate and are for illustrative purposes only. While we cannot doubt the floor plans accuracy, we make no guarantee, warranty or representation as to the accuracy and completeness of the floor plan