

8405/177-219 Mitchell Road ERSKINEVILLE NSW

2  2  1 

Tucked away on the fringe of Sydney's Inner West, this stylish two-bedroom apartment offers a perfect balance of serenity & convenience. Framed by a leafy outlook, the light-filled open plan lounge & dining area flows effortlessly to a covered balcony, creating the perfect retreat for relaxed indoor/outdoor living. Freshly updated interiors give the home a modern, move-in ready feel, while practical design ensures everyday comfort. Positioned in one of Erskineville's most desirable pockets, you'll be surrounded by green streetscapes & just moments from local schools, cafés, boutique shops & excellent transport links - making it an ideal choice for those seeking both lifestyle & connectivity.

Double brick & quality building

[For full version visit the website](https://www.beaumccaffery.com.au)

Type : Apartment
Price : \$ 1,100,000
Building Size : 109 sqm
View : <https://www.beaumccaffery.com.au/8488585>



Melissah McCaffery J P
02 9565 5333



Michael McCaffery
02 9565 5333

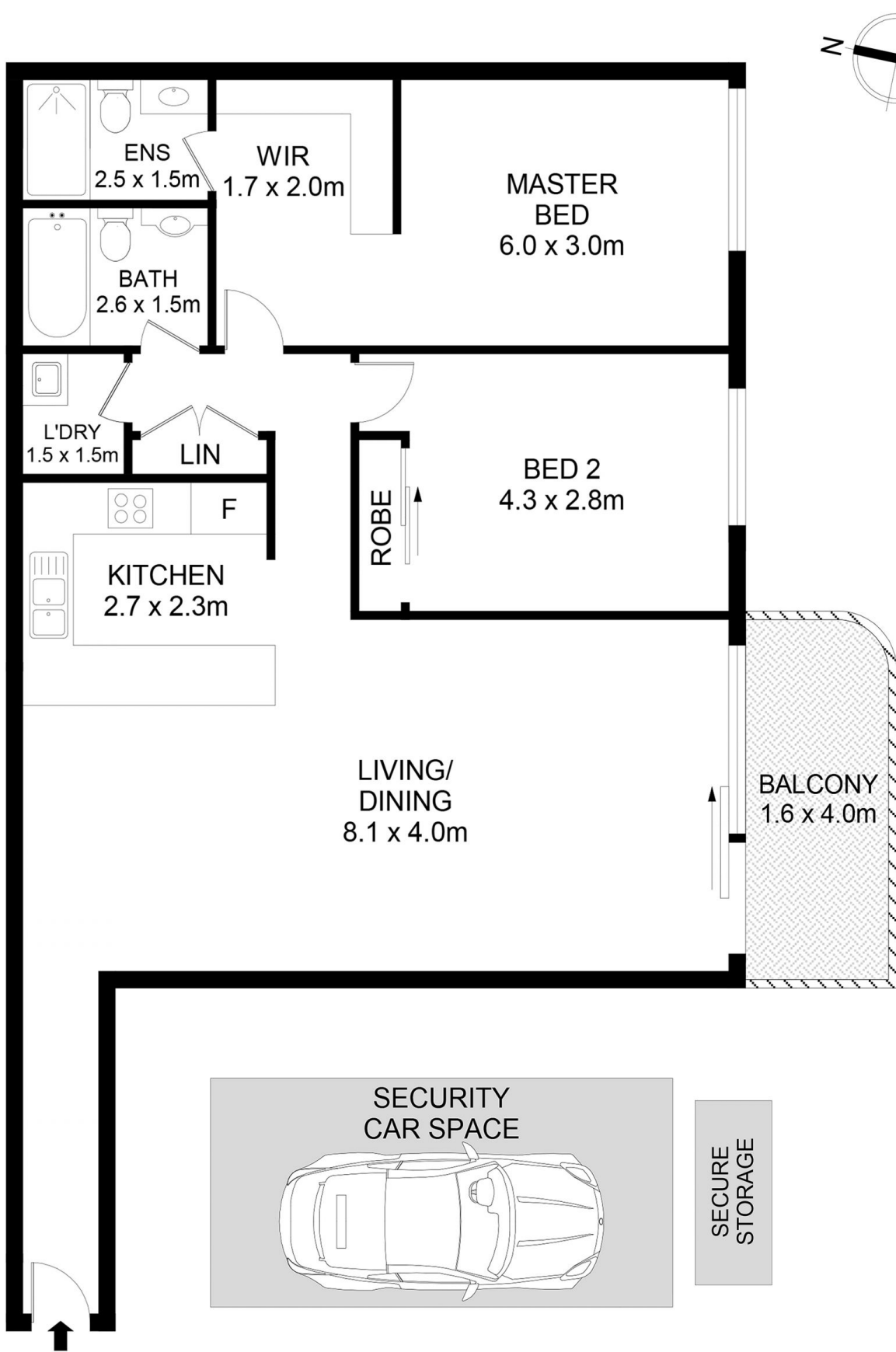

Disclaimer

Floor Plan measurements are approximate and are for illustrative purposes only. While we cannot doubt the floor plans accuracy, we make no guarantee, warranty or representation as to the accuracy and completeness of the floor plan