

**17410/177-219 Mitchell Road ERSKINEVILLE NSW**

1  1  1 

Situated in a prominent resort-style complex, this one bedroom + study apartment offers an elevated, light-filled layout w/ a tranquil outlook across the swimming pool & landscaped gardens. The home delivers an easy, low-maintenance lifestyle within one of Erskineville's most tightly held communities. The open-plan living & dining area flows seamlessly to a covered balcony overlooking the pool - an inviting space to entertain or unwind while enjoying the leafy, resort-style surrounds. A separate study provides valuable flexibility for working from home, while the generous bedroom is complemented by a walk-in robe & new modern bathroom with integrated laundry. Well-proportioned & easy to live in, the apartment is an ideal first step into the Inner West, offering a flexible layout, appealing outlook & a low-maintenance lifestyle close to

**Type** : Apartment  
**Price** : \$ 930,000  
**Building Size** : 90 sqm  
**Land Size** : 90 sqm  
**View** : <https://www.beaumccaffery.com.au/8612916>



**Melissah McCaffery J P**  
02 9565 5333



**Michael McCaffery**  
02 9565 5333

[For full version visit the website](https://www.beaumccaffery.com.au)

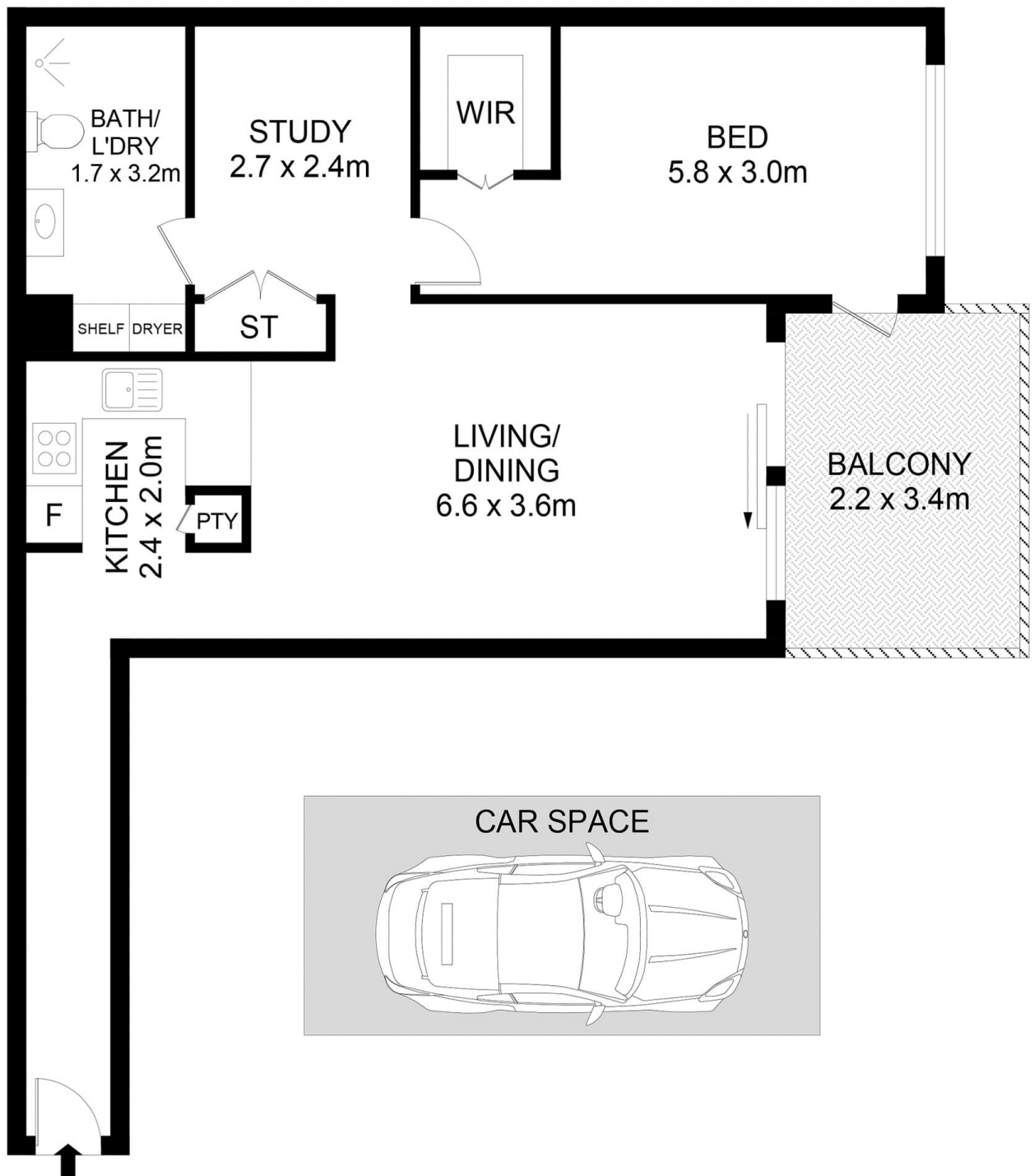

**Disclaimer**

Floor Plan measurements are approximate and are for illustrative purposes only. While we cannot doubt the floor plans accuracy, we make no guarantee, warranty or representation as to the accuracy and completeness of the floor plan

